

AREA SCHEDULE

2 X 4x CLASSROOM BLOCK	369.50sqm
1 X 2x GRADE-R	275.74sqm
20 x SEATS ENVIROLOO 21.9 x 6 BLOCKS	131.4sqm
1 X SMALL ADMIN BLOCK	179.24sqm

LEGEND

	PROPOSED
	FUTURE

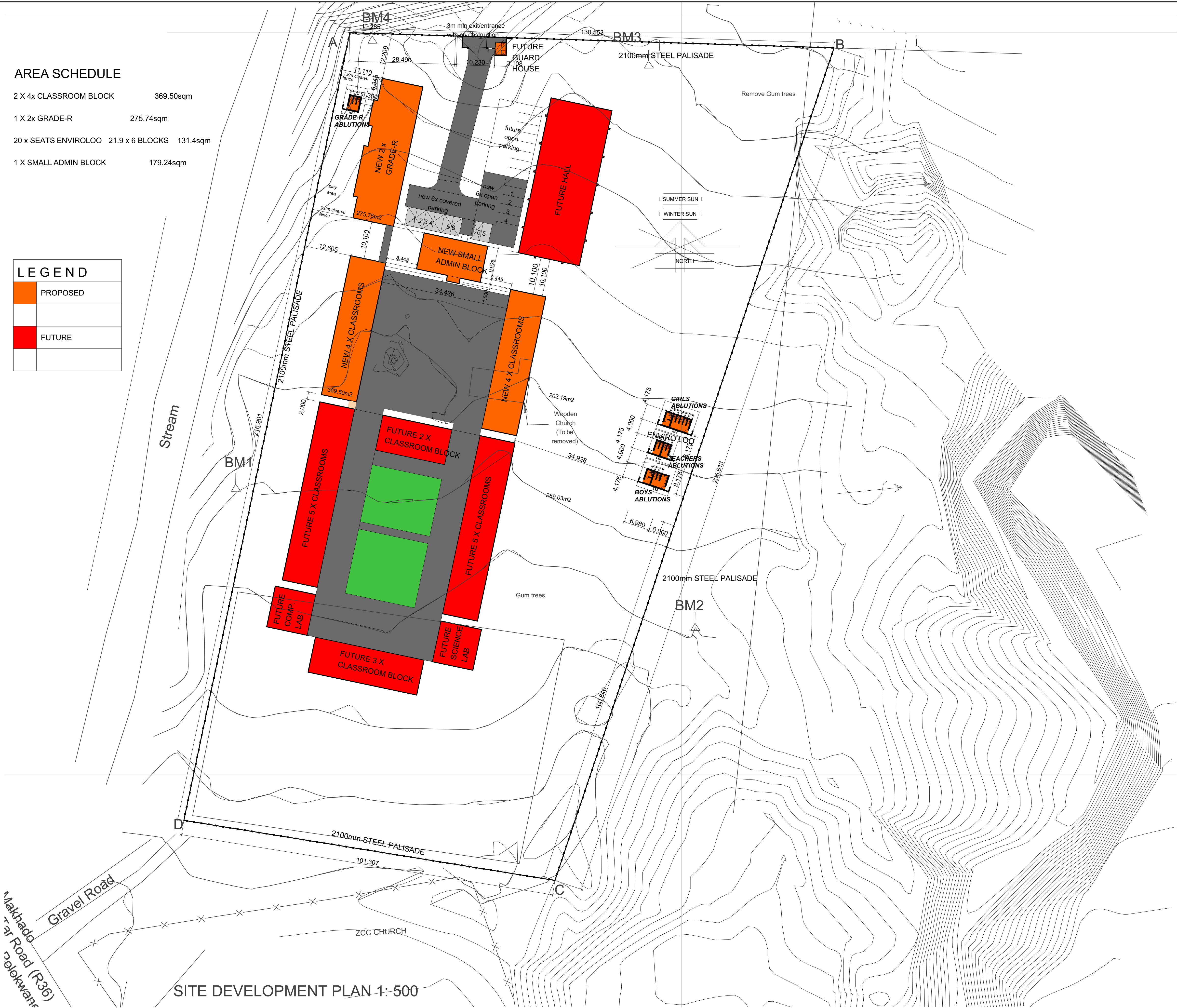

SITE DEVELOPMENT PLAN 1: 500

ALL DIMENSIONS ARE INDICATED IN MILLIMETRES AND MUST BE CONTROLLED ON SITE. THIS DRAWING MUST NOT BE SCALED. ONLY FIGURED DIMENSIONS MAY BE USED.

NOTES:

- \* ALL DIMENSIONS AND LEVELS ARE TO BE VERIFIED ON SITE PRIOR TO COMMENCING SETTING OUT WORKSHOP DRAWINGS OR CONSTRUCTION
- \* FIGURED DIMENSIONS ONLY TO BE USED.
- \* DISCREPANCIES, ERRORS AND DIMENSIONS ARE TO BE REPORTED TO THE ARCHITECT (EMPLOYER), IMMEDIATELY THEY BECOME EVIDENT.
- \* SHOP DRAWINGS TO BE SUBMITTED FOR APPROVAL PRIOR TO MANUFACTURE OR INSTALLATION.
- \* COPY RIGHT AND RIGHT OF REPRODUCTION OF THIS DRAWINGS OR ANY PORTION THEREOF IS RESERVED BY STUDIOE-DESIGN.

REFERENCE DRAWINGS

DRAWING NAME	No.

REVISIONS

Rev	Description	Date
Rev 13	Scope revised as per IDT + DOE + QS	16/08/21
Rev 12	Scope revised as per IDT + DOE + QS	13/04/21
Rev 11	Revised legend as per proposed buildings	11/07/19

STUDIOE-DESIGN

**studioe-DESIGN**  
architecture + design  
www.studioe-design.co.za

37 df malan avenue  
centurion.0157  
tel: 012 664 0168  
cell: 078 402 9298  
email: info@studioe-design.co.za

Client



Client

DEPARTMENT OF EDUCATION  
LIMPOPO C/O IDT



Project Name:

PROPOSED 8 CLASSROOMS,  
SMALL ADMIN BLOCK WITH 6 COVERED  
PARKING AND 6 OPEN PARKING  
2 GRADE R FACILITIES,  
20 x ENVIROLOO TOILETS  
ERECT THE STEEL PALISADE FENCE.DRILL,  
SEPTIC TANK AND EQUIP BOREHOLE FOR  
DEPARTMENT OF EDUCATION LIMPOPO AT  
AT MAKELLE PRIMARY SCHOOL

Drawing Name:

PROPOSED NEW SITE DEVELOPMENT PLAN  
FOR MAKELLE PRIMARY SCHOOL

Drawing No.

WD-00500-14 SITE PLAN

Revision	13													
----------	----	--	--	--	--	--	--	--	--	--	--	--	--	--

Scale 1 : 50	Designed	D Masha	16/08/2021
	Drawn	D. Masha	16/08/2021
	Checked	K.Mangala	16/08/2021

APPROVED

DATE